

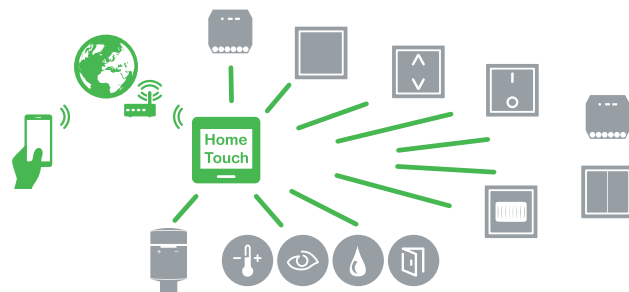

Wiser™

Schneider
Electric



Product information

Overview of system
Functions

- Getting to know Wiser** **3**
- Wiser system** **4**
 - Applications 5
 - Room control 6
 - Networked operation without the Wiser app 7
 - Individual operation using the Wiser app 7
 - Parallel operation via the Wiser app 7
 - Home control 8
 - Operation via the Internet 8
- Wiser app** **9**
 - Setting up the Wiser app 10
 - Downloading the Wiser app 10

- System requirements 10
- Creating a user account 11
- Setting up the GPS approval 11
- Pairing Wiser devices** **12**
 - Room control 13
 - Pairing Wiser devices with one another 13
 - Pairing Wiser devices with the app 14
 - Home control 15
 - Pairing Wiser devices with the app 15
 - Converting Wiser devices 15
 - Firmware update 16
 - Resetting the device 16

- Wiser Home Touch** **18**
 - Setting up Wiser Home Touch 19
- Wiser devices** **20**
 - Functions and settings 21
 - Getting to know Wiser devices 21
 - Advanced settings 24
 - Behaviour of the status LED 26

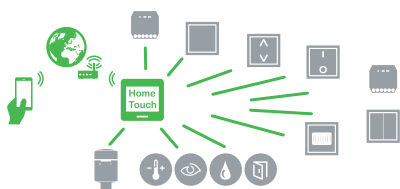

Wiser system



Wiser app



Wiser Home Touch



Wiser devices

Wiser in your home

Wiser is a convenient, flexible system for controlling building functions.

Wiser offers you a wide range of solutions for your home to meet your preferences and requirements. These start with simple control solutions for individual lights or blinds, all the way up to multi-device room control systems and even full home control systems.

You can conveniently set and run all these options via the Wiser app. You can also add a wide range of Wiser devices to the Wiser app on your smartphone or tablet.

Wiser maximizes your convenience.

The Wiser app

- Intuitive app for controlling lighting, blinds and heating
- Convenient overview of the status of connected devices
- Responds immediately to your actions
- Device pairing and setup in the app
- In the Wiser system, moments are the new way of programming actions of one or more Wiser devices. Moments control your devices according to your requirements for particular occasions – whether you are at home or out and about, and whether you want to read, watch TV or go to sleep. The corresponding moment in the app triggers the actions of one or more devices – either manually or on a time switch.
- Individual settings for each device
- Enables software updates for your devices



About this product information

This document provides an overview of the Wiser system, helps you with setup and contains information about the functions and settings of Wiser devices.

The operating instructions

Always observe the information in our operating instructions for installation, operation and the technical data.



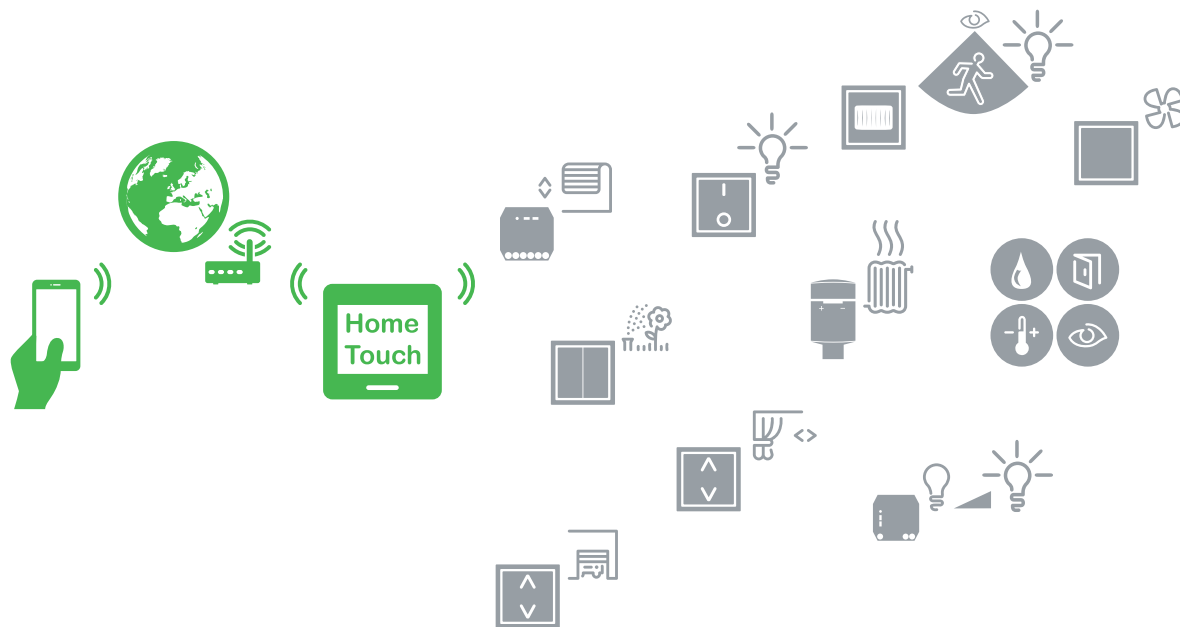

The Wiser app can be used to switch or dim lamps, move or position blinds, and even set the heating to come on at your preferred temperature just before you get home. Or you can leave this task to the moments that you can program once and then call whenever you want.

You can respond immediately to messages sent to your smartphone, e.g. if a water sensor is tripped, you will be informed at any time.

In this way, Wiser offers you maximum convenience and additional security for your home.

Whether you want to control individual lamps, a room or even your whole building, you can quickly adjust Wiser to your individual needs. The key to this convenience is the [Wiser app](#). This is the hub of the Wiser system, and is used to control all the devices connected to it.

For orientation purposes, the following configuration levels are available:

Room control – operation of the devices in a room

- Networked operation without the Wiser app
- Individual operation of the Wiser devices using the Wiser app
- Simultaneous operation of multiple Wiser devices using the Wiser app with moments

Home control – operation of the devices throughout the house

- Operation with Wiser Home Touch or the Wiser app – in your own network or externally via cloud access with the Wiser app.



Wiser sensors

- Sensors for a variety of monitoring functions, e.g.:
 - Movement detection
 - Detecting whether windows and doors are open
 - Temperature and humidity
 - Detecting water leaks

Operate your Wiser devices with ease and convenience in a single room.

The following options are available for this:

- Wiser motion sensor with switch or dimmer
- Wiser switches, dimmers or blind control switches
- Wiser switching modules, dimmer modules or blind modules
- Battery-powered Wiser push-buttons that can be freely positioned, e.g. for operation of Wiser modules
- Wiser push-button modules that can be combined with a range of flush-mounted inserts
- Wiser sensors
- Your smartphone with the Wiser app

The devices are paired either with the Wiser app or directly with one another – depending entirely on your needs.

The Wiser devices and the app are connected via Bluetooth. In order for two Wiser devices to communicate, they must be within Bluetooth range of one another.

This also means that the room control system is not necessarily limited to a single room. Instead, the limits of the connection are defined by the Bluetooth range. If you have a connection to an adjacent room, for example, there is nothing stopping you from using the room control system to control another area as well.

You can control the room in just three steps:

- ① Install Wiser devices (see operating instructions)
- ② [Setting up the Wiser app](#)
- ③ [Pairing Wiser devices](#)

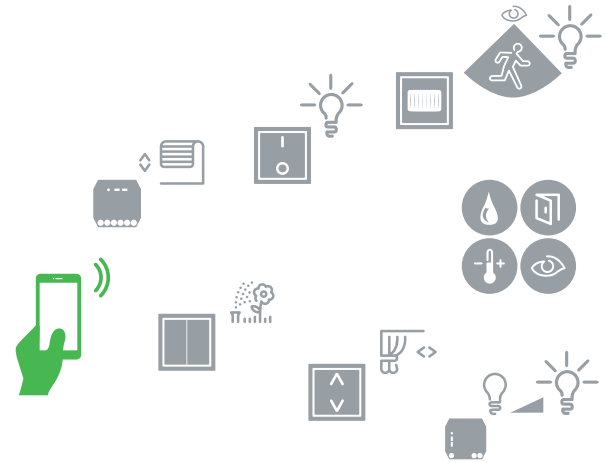

+ **Wiser room control**

- Easy pairing of multiple devices with one another or with the Wiser app
- Bluetooth transmission
- Devices must be within Bluetooth range



The room control system offers the following control options:

Networked operation without the Wiser app

For certain applications, you can also set up a room control system using only Wiser devices – without the need for the Wiser app.

For example, you can connect Wiser modules to one or more Wiser push-buttons – flexibly and according to your specific requirements. Or you can pair two Wiser push-button modules to set up a simple alternating switch system without any additional wiring.

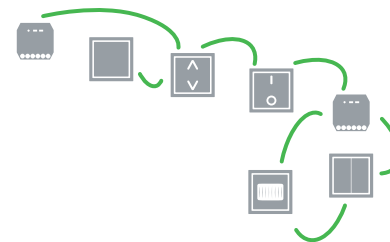

Individual operation using the Wiser app

With the Wiser app, you can control all Wiser devices individually.

To do this, pair the device in question with the app. This will allow you to adjust specific settings and set actions to run automatically. To do so, simply set up individual moments.

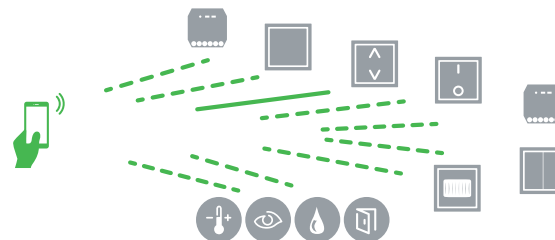

Parallel operation using the Wiser app

You can use the Wiser app to control multiple Wiser devices with a single operating step – simply create a moment with multiple Wiser devices.

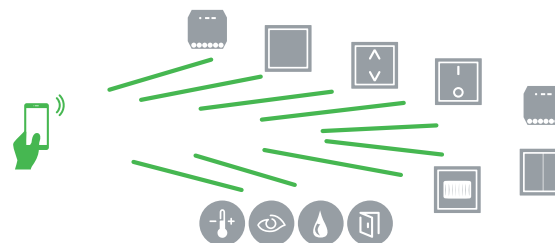

Operation via Wi-Fi

Is a single room not enough for you?

Then why not use Wiser with Wiser Home Touch to control functions in your entire building – either using your own home network or from anywhere in the world via a cloud connection.

All the Wiser devices that you can connect in a room control system can also be used for your home control system.

You can convert devices you have already used for room control (see [Converting Wiser devices](#)) so that they can be controlled via Wiser Home Touch. In this way, you will no longer be restricted by the Bluetooth range of the devices.

You will need the following items to set up a home control system:

- Wiser devices
- The [Wiser Home Touch](#)
- Your own Wi-Fi router
- Your smartphone with the [Wiser app](#)

The Wiser Home Touch acts as the central transmission device in your Wiser network. It connects your smartphone to your Wiser devices via your router. In this system, your smartphone and Home Touch will communicate via Wi-Fi.

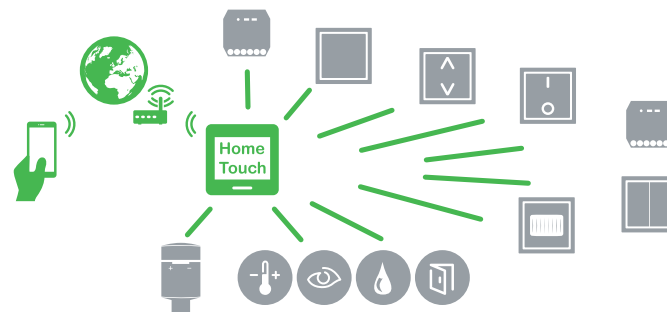

Wiser home control

- Easy pairing of multiple devices with the Wiser app
- Wiser Home Touch as a central communication element
- Wi-Fi transmission
- Wiser Home Touch setup in a few simple steps
- Worldwide access to your Wiser system (see [Wiser Home Touch](#))

The Wiser app



Downloading the Wiser app

In order to configure and control your Wiser devices, you need the *Wiser app*. The *Wiser app* is designed for use on smart devices, such as smartphones and tablets.

- ① Open the *App Store* or *Google Play*.



- ② Search for the *Wiser app*.
- ③ Download the *Wiser app* and install it on your smartphone.

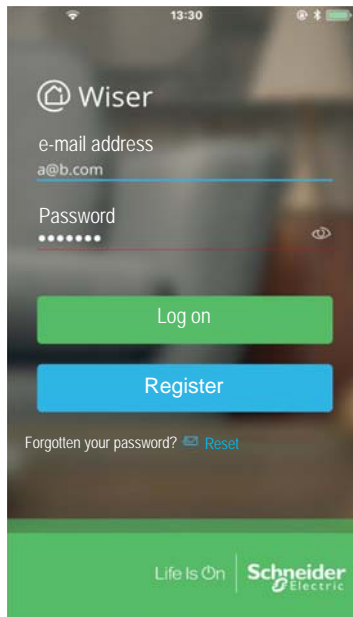

System requirements

Your smartphone must fulfil the following minimum technical requirements:

Bluetooth interface:

Bluetooth Smart Ready V4.1 or higher

Operating system:

Android™ Version 5.1 or higher

Apple® iOS 10.3 or higher

The compatibility of the interfaces with smartphones and tablets depends on the end device in question, and may change if the end device receives a new software version. Due to the large number of smart devices on the market, we cannot guarantee the unrestricted compatibility and functionality of your smartphone with the Wiser app.

Creating a user account

You will need a user account in order to use the Wiser app. This account will allow you to log into the app so that you can connect it to your Wiser system.

You create the Schneider Electric user account the first time you use the Wiser app.

The app will guide you through the registration process step by step.

- Enter your name
- Enter your e-mail address
- Select a password. The strength of the password is checked during entry.
- Accept the general terms and conditions
- Confirm the registration using the link sent to you via e-mail.

Once you have registered successfully, you will be able to log onto Wiser using your name and password.

-  • You will not be asked to log in again unless you explicitly log out of the app. If you simply close the app, your login data remain active.
- If you forget your password at any time, you can easily reset it and assign a new password.

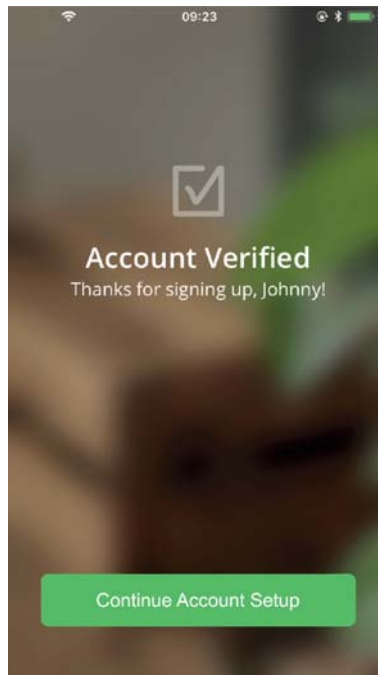

Setting up the GPS approval

After you log onto the *Wiser app*, it will request your approval to access your Bluetooth connection and GPS location. GPS approval is required in order to use the Astro function, and is a prerequisite in the Android operating system for actively searching for Bluetooth devices. GPS approval is therefore mandatory for pairing with devices.



Help with operation in the app

The Wiser app guides you through the setup of your Wiser system using step-by-step instructions.

It also provides explanations on operation and special functions.

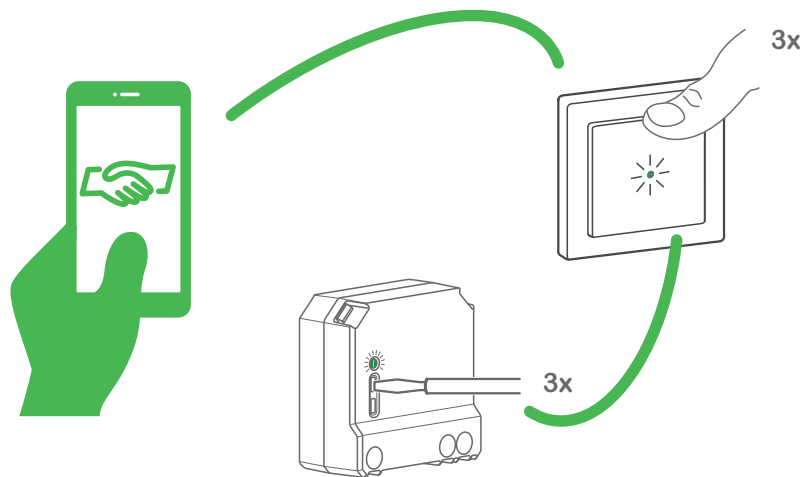

Pairing Wiser devices with one another

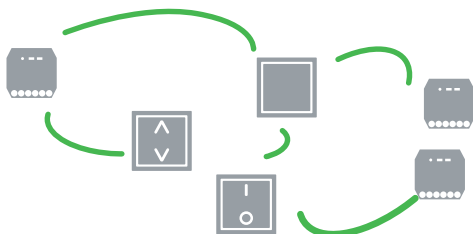

You can also control a Wiser device using another Wiser device, completely separately from the Wiser app. To do this, simply pair the two devices using Bluetooth.

Please note that you can only pair functionally identical Wiser devices, e.g. Wiser dimmers with other Wiser dimmers or Wiser devices for blind control with one another.

Pairing in two simple steps

The pairing procedure is identical for all Wiser devices.

- ① Activate pairing mode on the control device, e.g. a push-button module. To do so, press the pairing push-button 3 times.

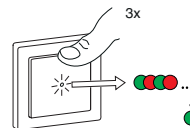

The status LED flashes, alternating between red and green.

- ② Activate pairing mode on the devices you wish to control, e.g. module. To do so, press the pairing push-button 3 times.

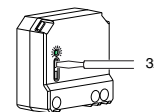

Once pairing has been completed successfully, the LEDs on the devices will flash green 4 times. The connected loads will be switched briefly as confirmation that the process was successful.

Pairing failed?

If the pairing attempt fails, the LEDs on the devices will flash red 4 times. The connected loads do not react.

In this case, repeat the pairing procedure.

Reciprocal pairing



You can also set up a reciprocal pairing connection between two or more Wiser devices. This means that the devices will control one another similar to an alternating switch system. To do this, repeat the pairing procedure for each additional Wiser device.

- ✎ • Communication via Bluetooth is a factory setting for all Wiser devices.
- You can pair a maximum of 10 Wiser devices with one another.
- Pay attention to the order in which you pair the devices.
- Keep both devices within Bluetooth range of one another during the procedure.
- Pairing mode is active for 30 s.

Pairing Wiser devices with the app

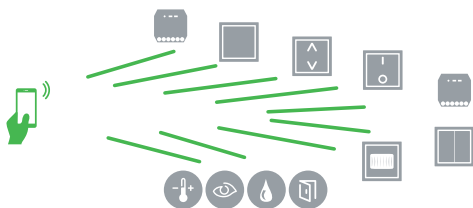

If you want to control your Wiser devices conveniently via your smartphone, you can pair them with the app via Bluetooth.

Pairing in four simple steps

The pairing procedure is identical for all Wiser devices.

To do this, you will first need to install the [Wiser app](#) and create a user account. The Wiser app will guide you through the pairing procedure step by step.

- ① Open the Wiser app.
- ② Select the "Add new devices" function.
- ③ Select the correct device type.



- ④ Activate pairing mode on the Wiser devices you wish to add.
To do so, press the pairing push-button 3 times.

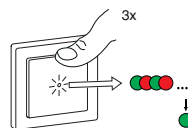
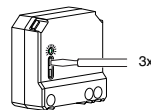

Once pairing has been completed successfully, the LEDs on the devices will flash green 4 times. The connected loads will be switched briefly as confirmation that the process was successful.

Pairing failed?

If the pairing attempt fails, the LEDs on the device will flash red 4 times. The connected loads do not react.

The Wiser app will also inform you that pairing has failed. In this case, repeat the pairing procedure.

- ✎ • Communication via Bluetooth is a factory setting for all Wiser devices.
- You can pair a maximum of 15 smartphones with the Wiser device.
- Keep both devices within Bluetooth range of one another during the procedure.
- Pairing mode is active for 30 s.

Pairing Wiser devices with the app

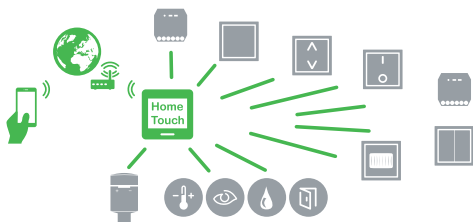

If you wish to network Wiser devices with one another in a home control system, you will first need to [Setting up Wiser Home Touch](#) and pair it with the Wiser app.

Once you have done this, you will also be able to pair all your other Wiser devices with the Home Touch. This is also done using the app.

The pairing procedure for the Wiser devices is identical to that used for a [Room control](#) with the Wiser app.

Converting Wiser devices

In order to use your Wiser devices with a home control system, they have to be converted by means of a firmware update. After doing this, you will no longer be able to pair these devices using Bluetooth.

The update is easy to perform using the Wiser app.

Depending on how your Wiser system is configured, you can do this one of two ways:

Setting up a new Wiser system as your home control system

If you set up a home control system with Wiser Home Touch right from the start, every Wiser device will be switched to home control as soon as it is paired with the Wiser app. No further action is required.

In this case, start pairing your devices with Wiser Home Touch.

Upgrading an existing room control system to home control

If you expand your room control system into a home control system using Wiser Home Touch, all the Wiser devices of the room control system paired with the Wiser app will be detected by Wiser Home Touch. You can then start the conversion procedure once in the Wiser app for all the Wiser devices that have been detected. Everything else is carried out automatically.

- ✎ • When you convert your Wiser devices to a home control system, all previously programmed moments of the Wiser devices and their connections to the room control system will be lost.
- During conversion of the Wiser devices, your smartphone must remain in range of your router's Wi-Fi and within Bluetooth range of the Wiser devices.



Help in the app

All the steps required to pair and convert Wiser devices are explained in detail in the app.

Firmware update

As soon as your Wiser devices are paired with the Wiser app, they will be updated regularly. This ensures continual improvement, maximum compatibility with new smartphones and expanded functionality.

The device updates are carried out by updating the Wiser app. It is thus important to make sure that the Wiser app on your smartphone is always up to date.

Resetting a device

In certain cases, it may be necessary to reset your Wiser device. There are three ways to do this.

Deleting pairing data

Possible applications:

- You have paired multiple Wiser devices and want to remove one Wiser device from this room control system.

Effects:

- Deletes all Bluetooth connection data

Use the pairing push-button on the device for this function.

- ① Press the push-button 3 times in quick succession.
- ② Then hold the push-button down for more than 6 seconds.

The status LED lights up green once.

- ③ When it does, release the button.

The status LED goes out. The Bluetooth connection data of the device have been deleted.

Restoring the factory settings

Possible applications:

- If you wish to delete your settings
- If you wish to remove your Wiser device from a room control system

Effects:

- Deletes all settings
- Deletes all moments
- Deletes all connection data

The **Reset settings** button is available for this under **Advanced settings** in the Wiser app.

You can also use the pairing button on the device.

- ① Press the push-button 3 times in quick succession.
- ② Then hold the push-button down for more than 10 seconds.

The status LED will slowly flash red.

- ③ When it does, release the button.

The status LED will now light up continuously red. The device's default settings have now been restored.

Resetting to Bluetooth

Possible applications:

- If you wish to remove your Wiser device from a home control system and convert it to room control (Bluetooth)

Effects:

- Deletes all settings and connections in the same way as a factory reset
- Deletes all connections to the home control system

You will find this function under **Advanced settings** in the Wiser app.

You can also use the pairing button on the device.

- ① Press the push-button 3 times in quick succession.
- ② Then hold the push-button down for more than 20 seconds.

The status LED flashes red, slowly at first and then quickly after 10 seconds.

- ③ When it does, release the button.

The status LED will now light up continuously red. The device has now been reset to Bluetooth.



Getting to know Wiser Home Touch

Wiser Home Touch is the central hub for your Wiser system. It connects your Wiser products to one another so that you can control them from anywhere you like using the Wiser app.

Wiser Home Touch is more than just an interface between the devices, however. Thanks to its full-colour touch screen, it can also be used as a controller when you don't have your smartphone to hand.

Home / Away / Sleep modes

Set all of your Wiser devices to the same mode by simply tapping on the Wiser Home Touch screen.

Moments

Load your favourite moments after setting them up in the Wiser app

Intelligent thermostat

When used in combination with the Wiser heating control system, Home Touch becomes an intelligent thermostat for your home.



Installing Home Touch

Before installation, please read the operating instructions enclosed with your Wiser Home Touch. These explain in details all the steps you will need to perform.

Connecting Home Touch to the Wiser app

Once installation is complete, you can connect Wiser Home Touch to your Wiser system. First, connect Home Touch to the Wiser app.

- ① Open the Wiser app.
- ② Select the "Add new devices" function.
- ③ Go to the **Connectivity** area and select Wiser Home Touch.

 The Wiser app will then guide you through the rest of the commissioning procedure step by step.

Connecting Home Touch to the Internet

Wiser Home Touch is connected to the Wiser app and the Internet via Wi-Fi.

- ① Follow the detailed explanations in the Wiser app.



Getting to know Wiser devices

You can use Wiser devices to switch or dim your lighting or control your blind motors.

For indirect operation, you can connect an unlimited number of mechanical push-buttons as extension units. The maximum distance is 50 metres.

You can operate additional functions and settings via the Wiser app:

- Moments with Astro and random function
- Activate wake-up and sleep functions
- Activate nightlight
- Timer with and without prewarning
- Set min. / max. brightness
- Set LED operating mode manually
- Activate memory function
- Define initial brightness
- Define detection brightness
- Set overtravel time
- Set sensitivity
- Activate semi-automatic mode
- Select switch mode
- Activate orientation light
- Set blind running time

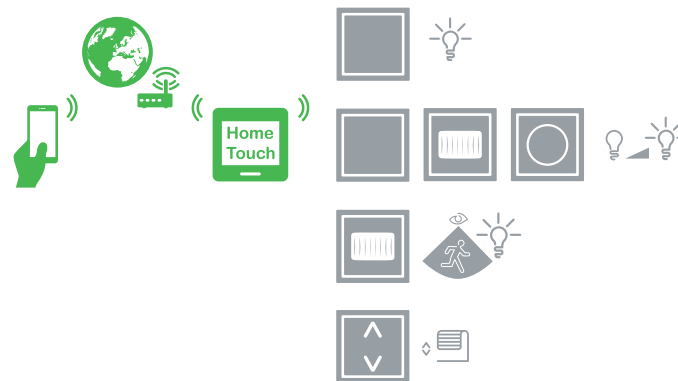

Key properties

- Devices in familiar design
- Easy to install
- Easy to retrofit in existing installations
- Easy to expand with additional devices
- Wireless device networking
- Software updates via the Wiser app

In addition to the basic switching, dimming and blind running functions, the Wiser app also offers a number of advanced functions.

You can set a *moment*, a *random function* and a *timer with prewarning*.

Setting up moments

You can set up *moments* with a time switch. In this way, the events can be triggered under timer control. You can store up to 16 independent events per Wiser device. An event always consists of a start time and the day / month on which the event will be carried out. You can also adjust the following settings:

- What is to be carried out: on / off, dimming value, wake-up / sleep function, nightlight, up / down (depending on the Wiser device)?
- Is the event to be carried out at sunrise / sunset (Astro function)?
- Is the event to be combined with a random function?

Setup is carried out under *Moments*.

Activating the random function

The random function varies the events configured for the time switch. This can be used to simulate your presence in the home while you are actually on holiday, for example. The system randomly deviates from the set time by up to ± 25 minutes for a set duration of max. 3.5 hours. If the set duration is longer, the deviation will be up to ± 51 minutes.

 The Wiser app explains in detail how to set up a moment and use the Astro and random functions.

Activating the sleep function (touch dimmer, rotary dimmer, motion sensor with dimmer)

The sleep function ensures that the light is dimmed within 30 minutes and then switched off.

Motion detection is deactivated during this time.

All other functions (manual, preset or via the Wiser app) cancel the sleep function.

In this case, the light lights up with maximum brightness.

Activating the wake-up function (touch dimmer, rotary dimmer, motion sensor with dimmer)

The wake-up function ensures that the light is switched on 30 minutes before the set waking time and slowly dimmed up until it has reached full brightness at the waking time.

All other functions (manual, preset or via the Wiser app) cancel the wake-up function.

Activating the nightlight function (touch dimmer, rotary dimmer, motion sensor with dimmer)

If the nightlight function is activated, the light is not switched off, but dimmed down to a value that you have set.

In the case of motion detection, the brightness is dimmed back up to the maximum value.

How does the timer work?

Using the timer, you can switch on lamps simply for the duration of the set overtravel time. This provides a very easy way of setting up a staircase lighting function without using an automated staircase lighting system.

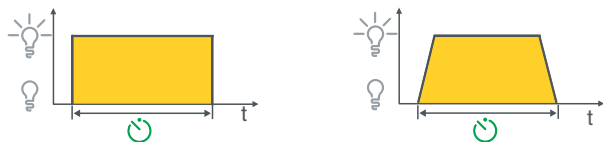

- ① Activate the timer.
- ② Set the overtravel time (1 s – 24 h).
- ③ Optional: Activate the **Staircase lighting** function to set the prewarning time.

What is the prewarning time?

The prewarning time reminds you that the lamp will be switched off in 30 seconds. In these 30 seconds, you have plenty of time to decide whether you want to restart the timer.

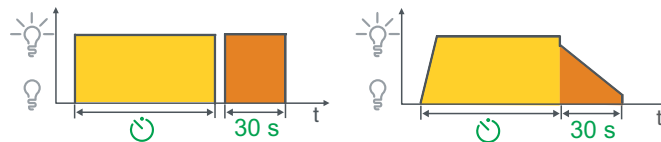

Once the overtravel time has expired, the lamp briefly switches off and then back on again. This is when the prewarning time of 30 seconds starts running.

If you assign the prewarning time to a dimmer, the lamp will be dimmed down for 30 seconds when the overtravel time expires.

Advanced settings

Every Wiser devices comes with **Advanced settings** that can be used to set special functions.

To access the special functions, proceed as follows:

- ① Open the **Wiser app**.
- ② Open the **Settings** in the main menu.
- ③ Select **Manage devices** to open the device overview.
- ④ Select the required device and open the settings for it.
- ⑤ Tap **Advanced settings**.

Depending on which device you select, you will now see the following advanced settings:

- Set min. / max. brightness
- Set LED operating mode manually
- Activate memory function
- Define initial brightness
- Define detection brightness
- Set overtravel time
- Set sensitivity
- Activate semi-automatic mode
- Select switch mode
- Activate orientation light
- Individual blind running time

Setting min. / max. brightness (touch dimmer, rotary dimmer, motion sensor with dimmer)

You can limit the dimming range by setting the minimum and maximum brightness. This can be useful if connected lamps (particularly LED lamps) flicker at low dimming values.

Limiting the maximum brightness can be useful if you wish to reduce your energy consumption, for example.

Switching to RL LED mode (touch dimmer, rotary dimmer, motion sensor with dimmer)

Most LED lamps are capacitive loads. They are automatically detected by the dimmer and controlled in RC mode.

Particularly with dimmable LED lamps, which can vary greatly in terms of the electronics used in them, the dimmer may not always recognise an inductive LED load correctly. If expressly recommended or prescribed by the lamp manufacturer, you can activate RL LED mode in such cases.

 In the load mode "RL LED mode", LED lamps can only be connected at up to 10% of the maximum permissible dimmer load.

Activating the memory function (touch dimmer, rotary dimmer, motion sensor with dimmer)

If the memory function is activated, the dimmer notes the brightness level that was last set. The memory function is activated automatically when you deactivate the initial brightness.

Setting the initial brightness (touch dimmer, rotary dimmer, motion sensor with dimmer)

With the initial brightness activated, you can determine the brightness level at which the lamps are switched on. For example, you can set the light in your hallway or bathroom to switch on at a low brightness level to give your eyes time to adjust.

Setting the detection brightness (motion sensor with switch or dimmer)

You do not want your loads to be switched on until the ambient brightness level falls below a specific threshold value. Set a detection brightness in the range 5-500 Lux.

Setting the overtravel time (motion sensor with switch or dimmer)

The overtravel time is used to set how long the light remains switched on after a motion has been detected before being automatically switched off. You can set the duration of the overtravel time to a value between 1 second and 30 minutes; the default value is 5 minutes.

Sensitivity (motion sensor with switch or dimmer)

You can set the sensitivity or range of your motion sensor. You can select between high (default), medium or low sensitivity.

Activating semi-automatic mode (motion sensor with switch or dimmer)

In semi-automatic mode, motion detection is only carried out if the load has been switched on manually beforehand. The load is switched off automatically.

Switch mode (motion sensor with switch or dimmer)

You can switch the motion sensor off and back on again as required.

Activating the orientation light function (relay switch, touch dimmer, blind control switch)







The status LED normally indicates the state of the switched load. If the load is switched on, the LED lights up red.

You can also use the LED as an orientation light in dark rooms. In this case, the LED lights up continuously green if the load is not switched on.







Setting the blind running time (blind control switch)

You can individually set the running time of your blind. The preset running time is 2 minutes and the maximum possible value is 5 minutes. This function enables you to keep your blind automatically at a desired position.



Pairing (see “Pairing Wiser devices”)

Status	User action	LED	Description
Normal			The LED is off. The Wiser device is working normally.
Room control	Press push-button 3x		The Wiser device is in pairing mode for a room control system (Bluetooth). Pairing mode is active for 30 seconds.
Room control		 4x	The Wiser device has been paired successfully.
Room control		 4x	Pairing for room control was not successful. Try again.
Home control	Press push-button 3x		The Wiser device is in pairing mode for a home control system (with Wiser Home Touch). Pairing mode is active for 30 seconds.
Home control			Pairing for home control was not successful. Start it again.





Resetting devices (see “Resetting Wiser devices”)

Status	User action	LED	Description
Delete pairing	Press push-button 3x and hold down 1x 6 s	 1x	The Bluetooth connection data of the device have been deleted.
to factory settings	Press push-button 3x and hold down 1x 10 s	 	The device is in reset mode. It is reset to the factory settings after 10 seconds. The device will then restart.
to Bluetooth	Press push-button 3x and hold down 1x 20 s	  	The device is in reset mode. It is reset to Bluetooth after 20 seconds. The device will then restart.



Relay switch

Status	User action	LED	Description
Normal	Push-button or extension unit: press 1x briefly Smartphone: use the Wiser app		The load is switched on.
			The load is switched off.

Touch dimmer

Status	User action	LED	Description
Normal	Push-button or extension unit: press 1x briefly Smartphone: use the Wiser app		The load is switched on.
			The load is switched off.
	Push-button or extension unit: press and hold down Smartphone: use the Wiser app		The load is dimmed up/down.
	Press the lower push-button 14x	 1x	The device has changed operating mode and is now in automatic mode.
		 3x	The device has changed operating mode and is now in RL-LED mode.



Rotary dimmer

Status	User action	LED	Description
Normal	Rotary knob or extension unit: press 1x briefly Smartphone: use the Wiser app		The load is switched on/off.
	Rotary knob or extension unit: press and hold down Smartphone: use the Wiser app		The load is dimmed up/down.
	Turn the rotary knob clockwise		The load is dimmed up.
	Turn the rotary knob counterclockwise		The load is dimmed down.
	Press the rotary knob 14x	 1x	The device has changed operating mode and is now in automatic mode.
		 3x	The device has changed operating mode and is now in RL-LED mode.





Motion sensor

Status	User action	LED	Description
Normal	Push-button or extension unit: press 1x briefly Smartphone: use the Wiser app		The load is switched on/off.

Motion sensor with dimmer

Status	User action	LED	Description
Normal	Push-button or extension unit: press 1x briefly Smartphone: use the Wiser app		The load is switched on/off.
	Push-button or extension unit: press and hold down Smartphone: use the Wiser app		The load is dimmed up/down.
	Press the push-button 14x	 1x	The device has changed operating mode and is now in automatic mode.
		 3x	The device has changed operating mode and is now in RL-LED mode.

Blind control

Status	User action	LED	Description
Normal	Blind stationary: Lower push-button or lower extension unit: press 1x briefly Smartphone: use the Wiser app	 1x	The blind moves one step downwards.
	Blind is moving: Push-button or extension unit: press 1x briefly Smartphone: use the Wiser app		The blind stops.
	Upper push-button or upper extension unit: press and hold down Smartphone: use the Wiser app	 during blind motion	The blind moves upwards for the preset running time. If the push-button is pressed while the blind is moving downwards, the motion is stopped and the blind moves upwards.
	Lower push-button or lower extension unit: press and hold down Smartphone: use the Wiser app	 during blind motion	The blind moves downwards for the preset running time. If the push-button is pressed while the blind is moving upwards, the motion is stopped and the blind moves downwards.

Cyber security

The Wiser system has been evaluated by the Schneider Electric Global Security Lab. This independent facility safeguards systems against current threats. It protects the Wiser system against cyberattacks. The modern security systems in place between Wiser devices, the app and the cloud services protect end user data using the same encryption technology as banks.

The Wiser app and all our software products are updated continually in order to protect against potential security risks.

Brand names

- Apple®, iTunes®, App Store®, iPhone®, iPod®, iPad® and MAC OS® are brand names or registered trademarks of Apple Inc.
- Google Play™, Google Play Store™ and Android™ are brand names or registered trademarks of Google Inc.
- Wi-Fi® (WLAN) is a registered trademark of the Wi-Fi Alliance.

Other brand names and registered trademarks are the property of the respective owners.

Schneider Electric Industries SAS

If you have technical questions, please contact the

Customer Care Centre in your country.

schneider-electric.com/contact

NU3526xx_NU5526xx_HWadd_EN