

INSTALLATION MANUAL

7046, 7047

ecolight



80 CRI



150cm
S

7046

230V | 10W | IP65 | Aluminium | Adjustable
Complete with 250mA driver. Supplied with spike.

7047

230V | 20W | IP65 | Aluminium | Adjustable
Complete with 500mA driver. Supplied with spike.

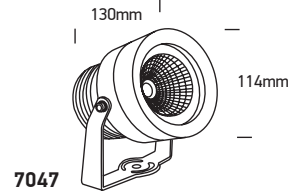
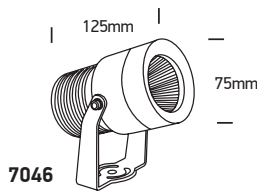

one
LIGHT

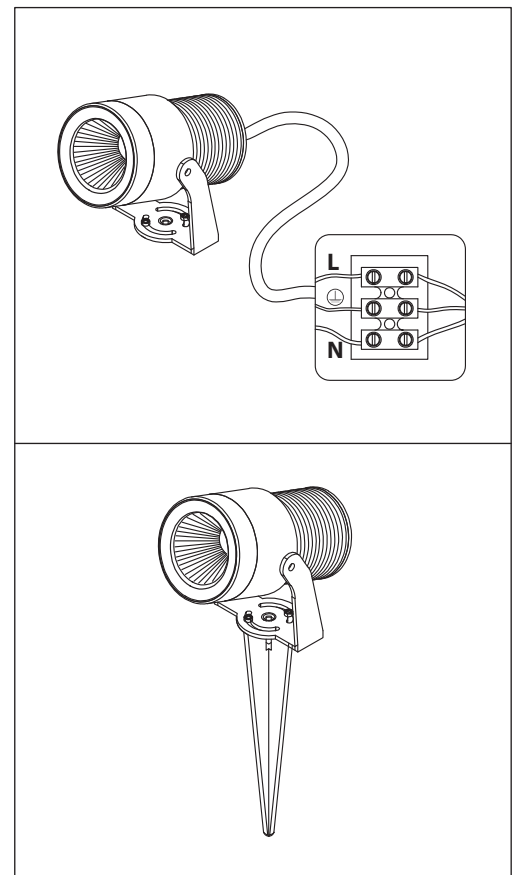
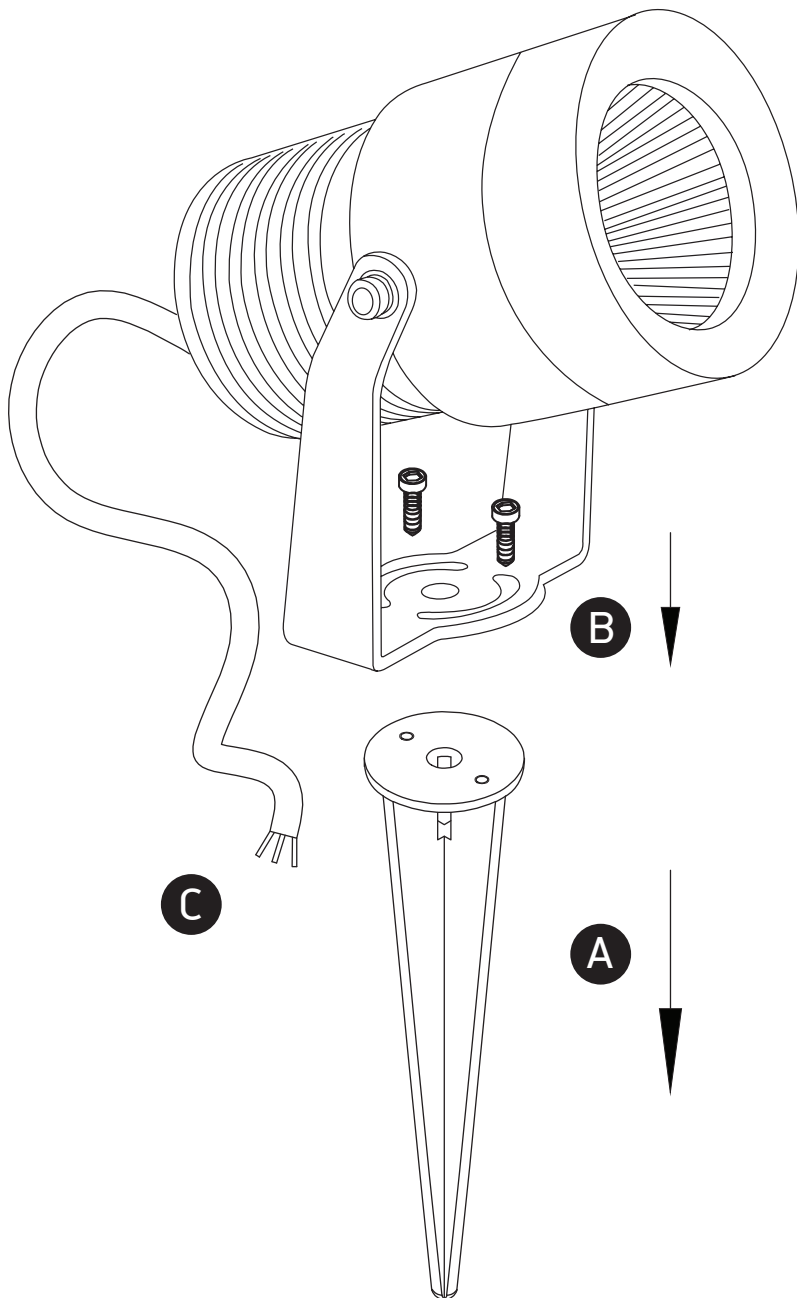

Warnings:

1. Make sure that the product is installed properly before connecting to electricity.
2. Do not cover the fitting.
3. Maintenance and installation should only be carried out by a professional electrician.