

INSTALLATION MANUAL

69042A, 69042B

ecoinground | III | DIMMABLE | IK08 | CE | RoHS | 85 CRI

1W | 350mA | IP67 | Natural aluminium
Requires 350mA driver.

Decking Installation: 30mm | 80mm

Concrete Installation: 35mm | 95mm+300mm drainage

200cm

37mm | 37mm | 60mm | 60mm

one
LIGHT

CONCRETE INSTALLATION

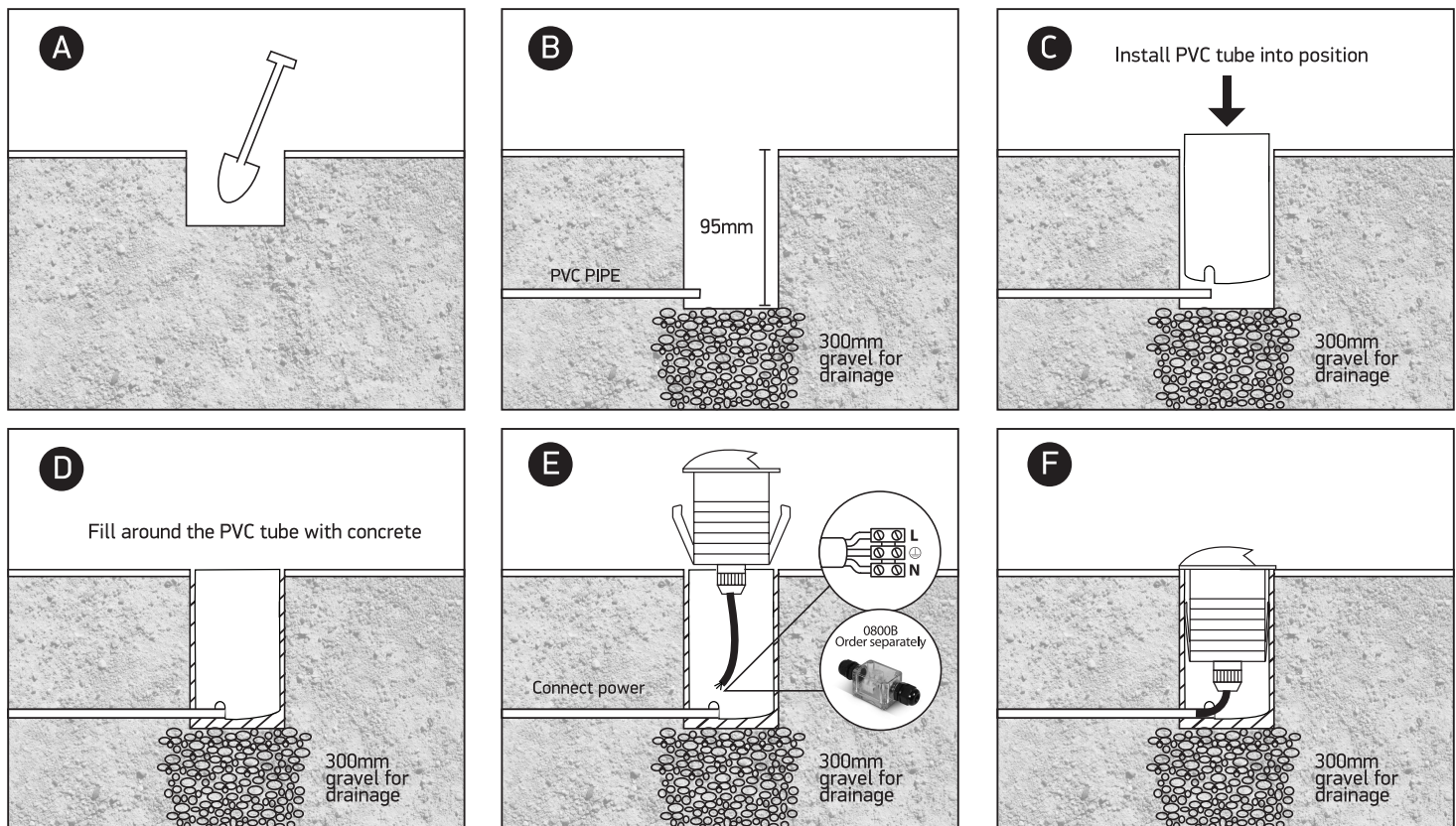

DECKING INSTALLATION

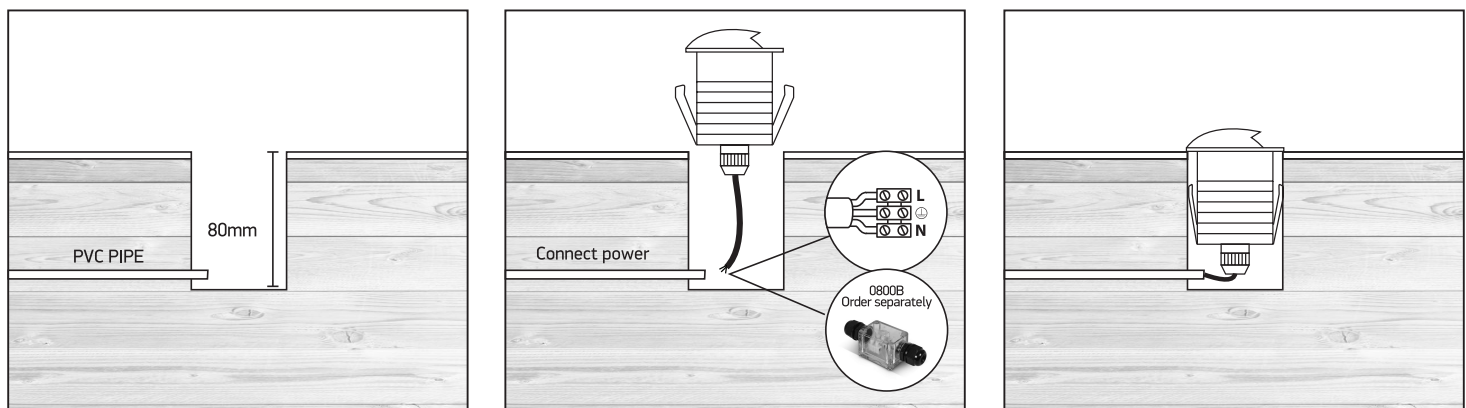

Warnings:

1. Make sure that the product is installed properly before connecting to electricity.
2. Do not cover the fitting.
3. Maintenance and installation should only be carried out by a professional electrician.