

INSTALLATION MANUAL

51230

LED
BUILT IN



90
CRI

CE EAC UK CA

RoHS
COMPLIANT



NOT
DIMMABLE

230V | COB LED | 2x30W | IP20 | Aluminium + metal
Complete with 750mA drivers.

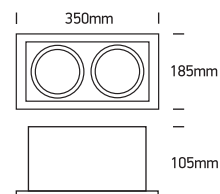
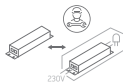

one
LIGHT

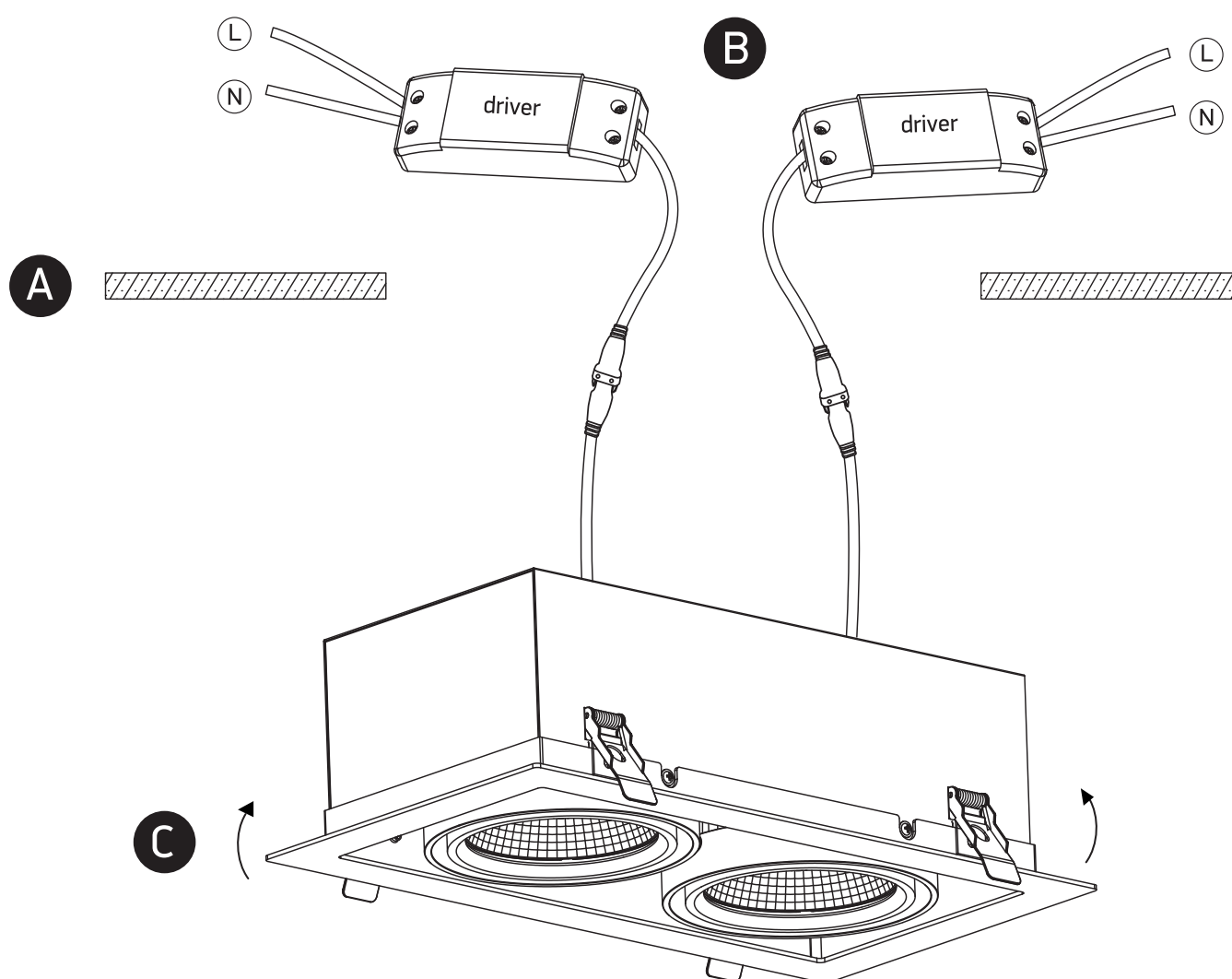

Warnings:

1. Make sure that the product is installed properly before connecting to electricity.
2. Do not cover the fitting.
3. Maintenance and installation should only be carried out by a professional electrician.