

# INSTALLATION MANUAL

## 51230

**LED**  
BUILT IN



90  
CRI

CE EAC UK CA

RoHS  
COMPLIANT



230V | COB LED | 2x30W | IP20 | Aluminium + metal  
Complete with 750mA drivers.

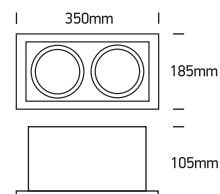
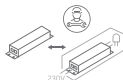

**one**  
LIGHT

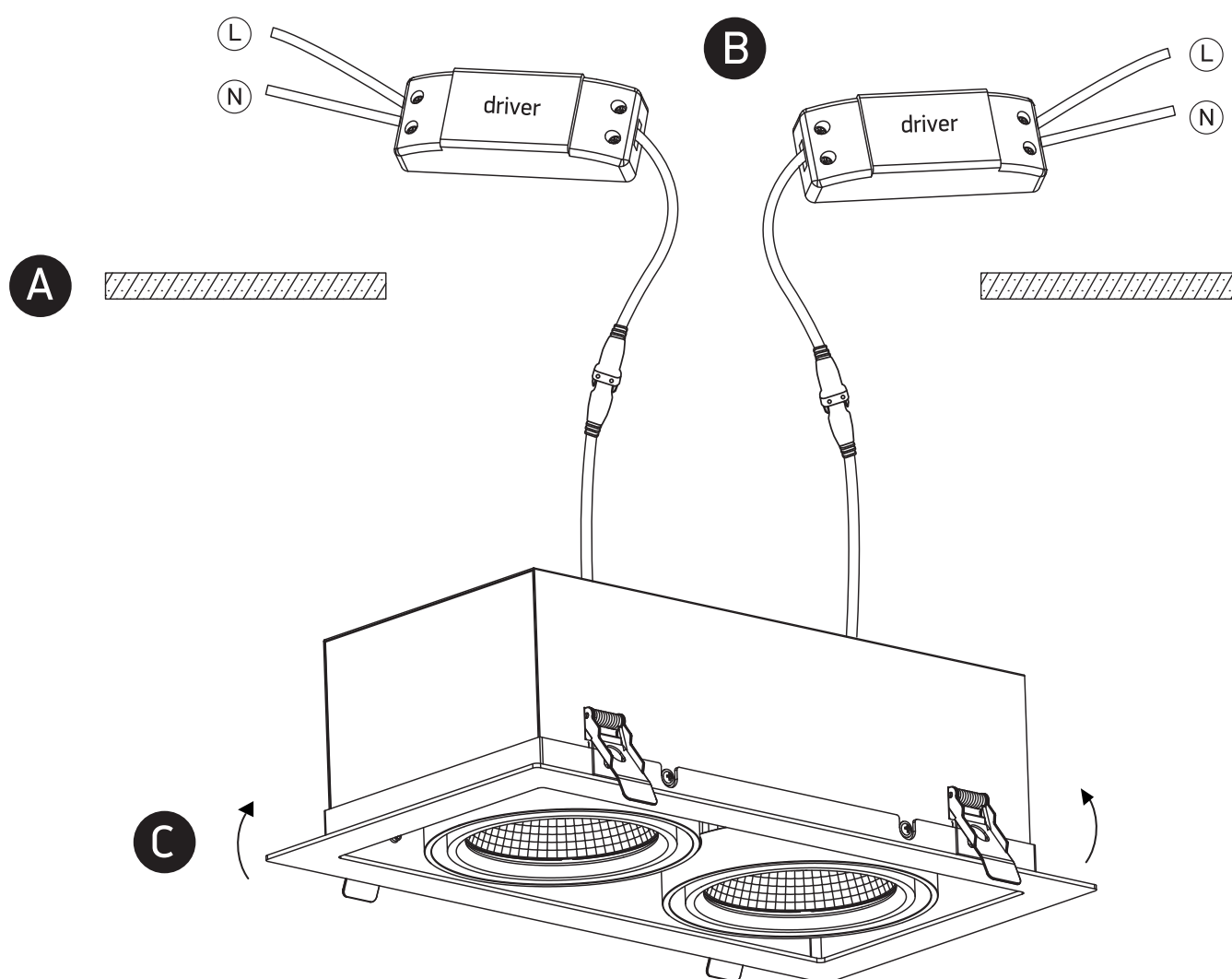

### Warnings:

1. Make sure that the product is installed properly before connecting to electricity.
2. Do not cover the fitting.
3. Maintenance and installation should only be carried out by a professional electrician.