

INSTALLATION MANUAL

10116FD

ecodownlight



**DARK
LIGHT**

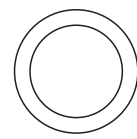

170mm



50mm

one
LIGHT

230V | SMD 2835 | 16W | IP20 | Die cast

Complete with driver.

**80
CRI**

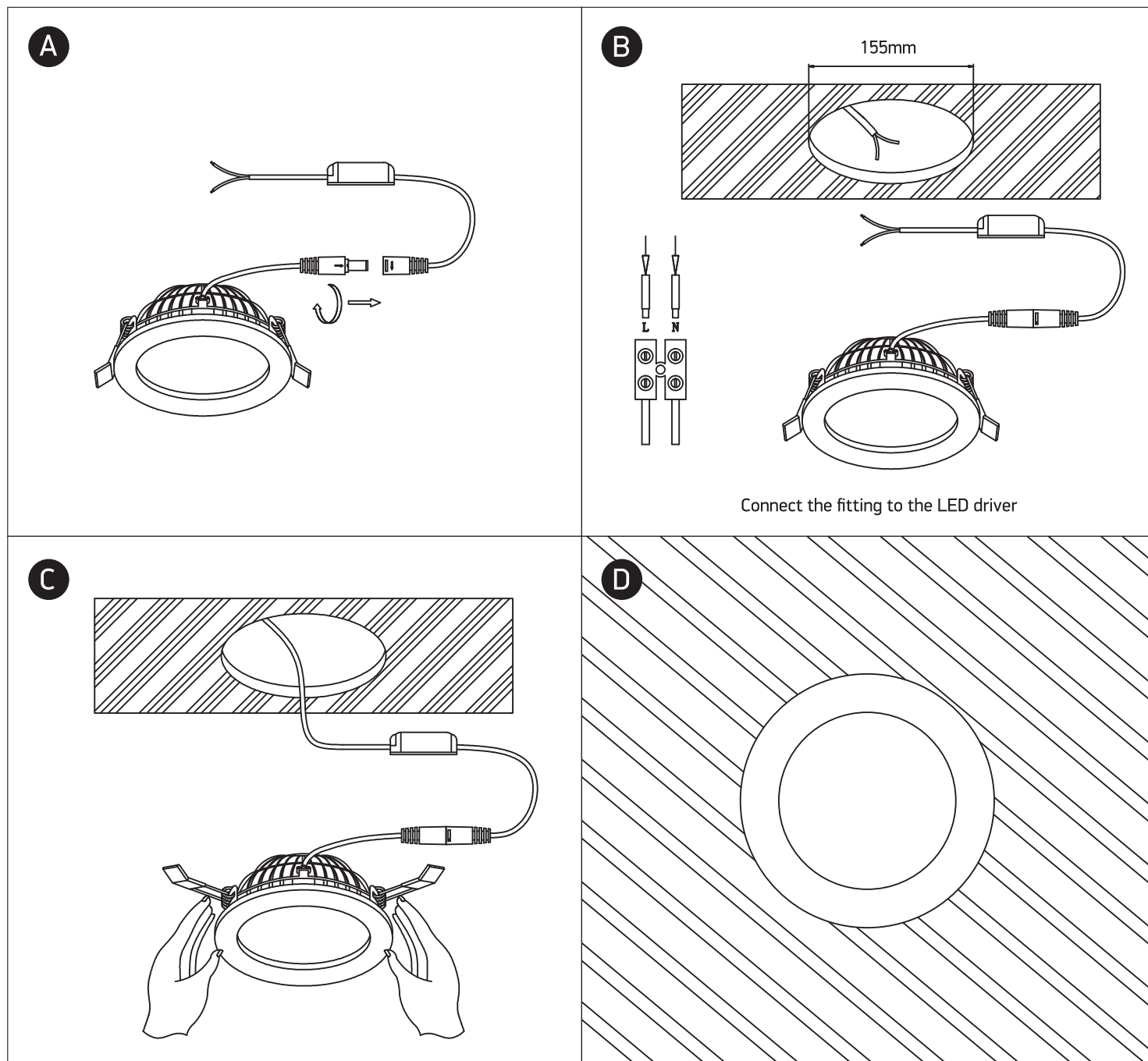
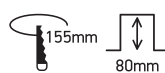

Warnings:

1. Make sure that the product is installed properly before connecting to electricity.
2. Do not cover the fitting.
3. Maintenance and installation should only be carried out by a professional electrician.