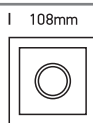

INSTALLATION MANUAL

11112H / 51112H

ecolight

**80
CRI**

108mm



95mm

 230V | 12W | IP20 | Aluminium | Adjustable
 Complete with driver.

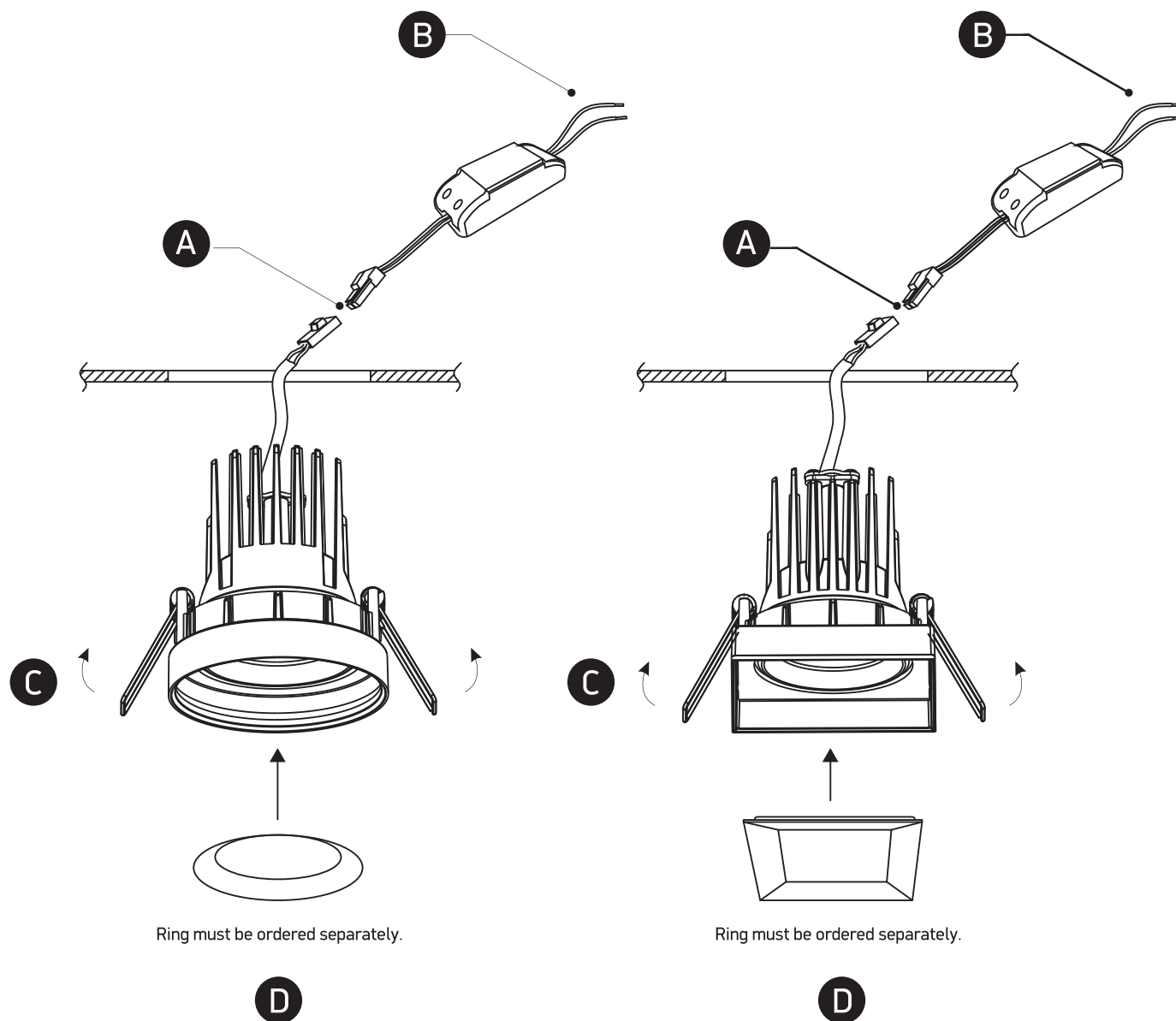
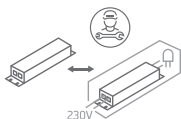
one
 LIGHT

Warnings:

1. Make sure that the product is installed properly before connecting to electricity.
2. Do not cover the fitting.
3. Maintenance and installation should only be carried out by a professional electrician.