

# INSTALLATION MANUAL

## 11109B

**ecolight**

500mA | COB LED | 9W | IP20 | Aluminium  
Requires 500mA driver.



Requires 500mA driver.

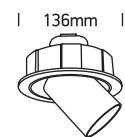

136mm

134mm

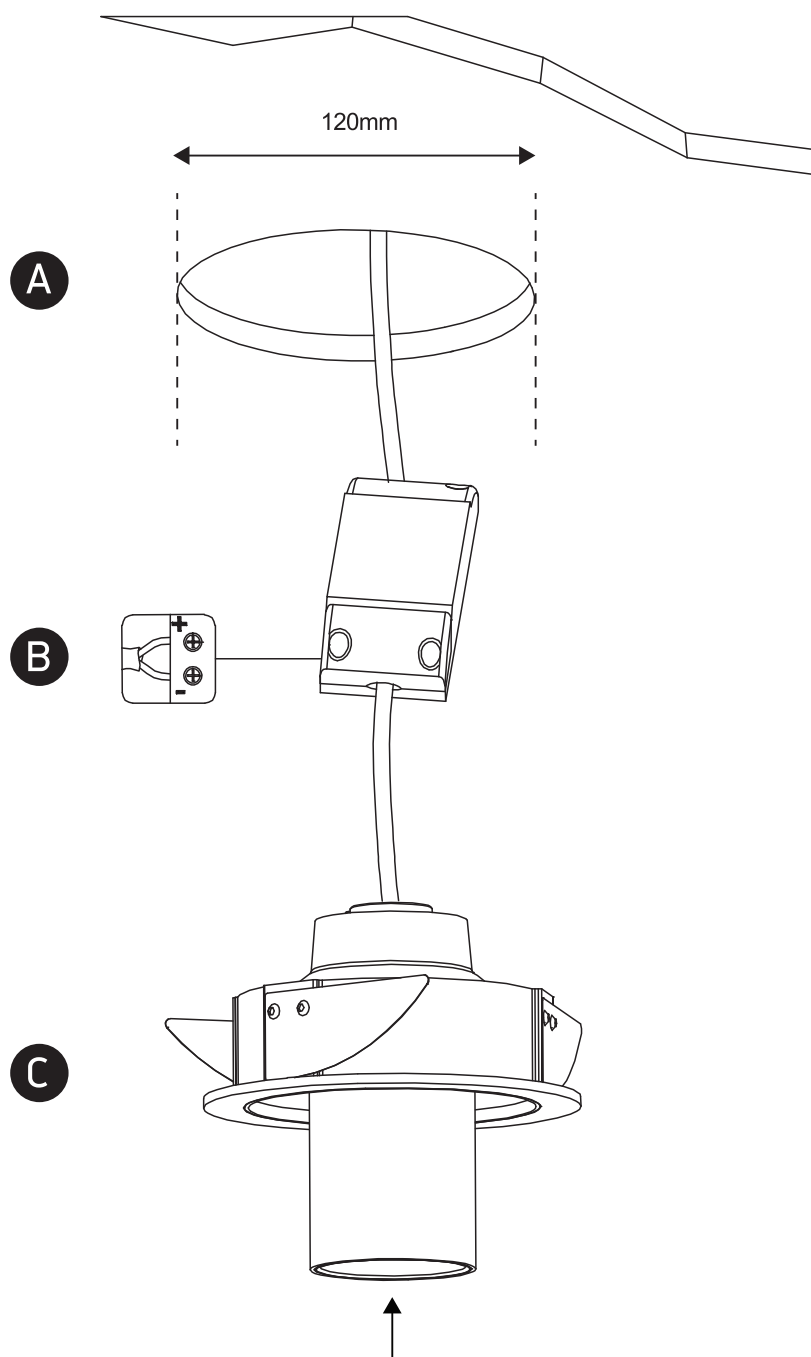
**one**  
LIGHT

### Warnings:

1. Make sure that the product is installed properly before connecting to electricity.
2. Do not cover the fitting.
3. Maintenance and installation should only be carried out by a professional electrician.