

# INSTALLATION MANUAL

## 10108CF

**ecodownlight**



80  
CRI

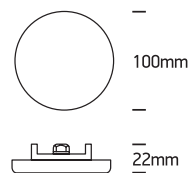

230V | SMD 4014 | 8W | IP65 | Die cast + PC  
Complete with 500mA driver.

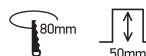

**one**  
LIGHT

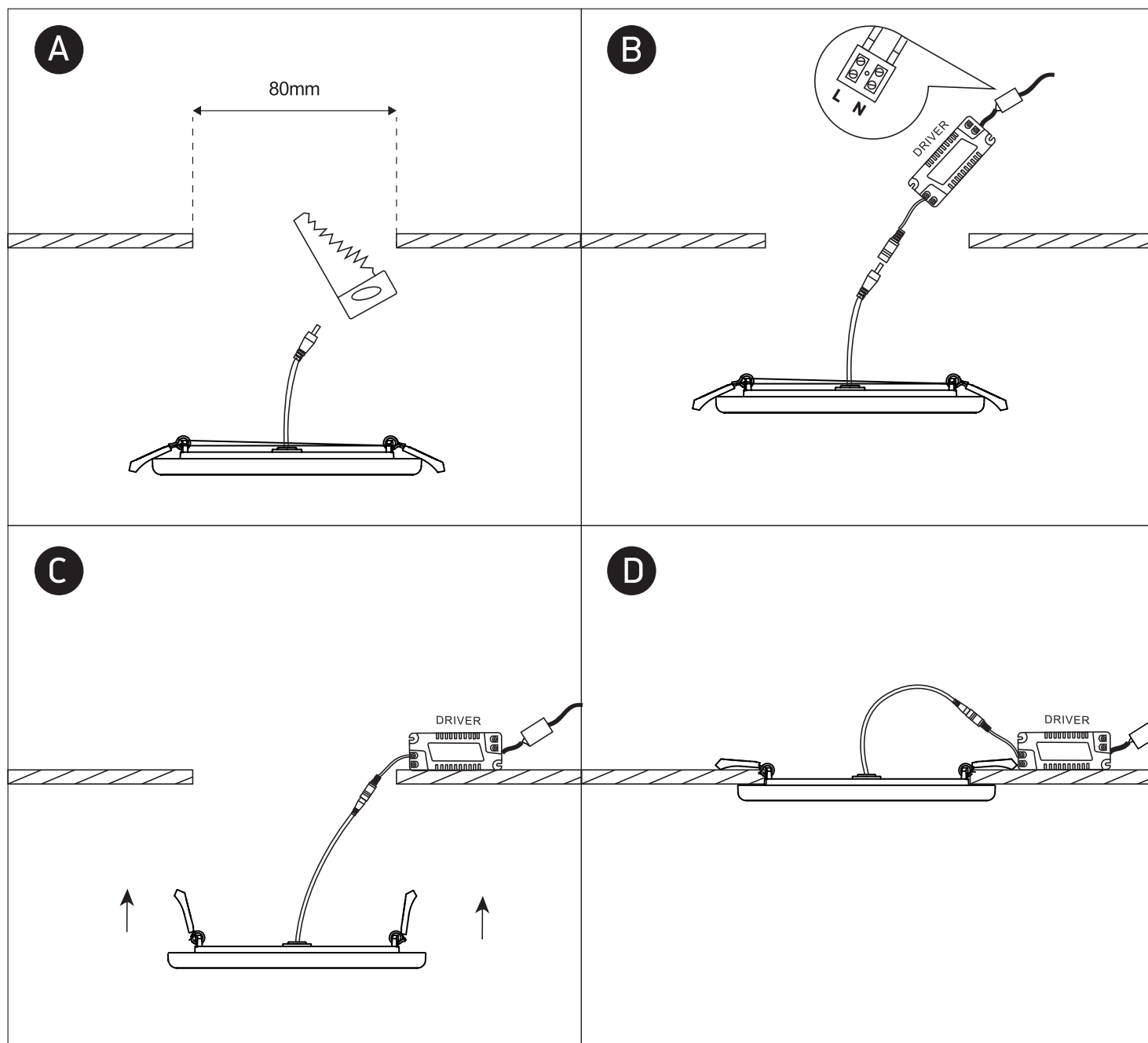

### Warnings:

1. Make sure that the product is installed properly before connecting to electricity.
2. Do not cover the fitting.
3. Maintenance and installation should only be carried out by a professional electrician.