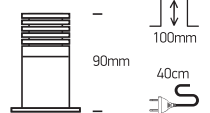

# INSTALLATION MANUAL

## 10107DL

**LED**  
BUILT IN

**DARK LIGHT**

**90 CRI**

700mA | COB LED | 6.5W | IP65 | Aluminium  
Requires 700mA driver.

**CE**
**EAC**
**UK**  
**CA**
**RoHS**  
COMPLIANT

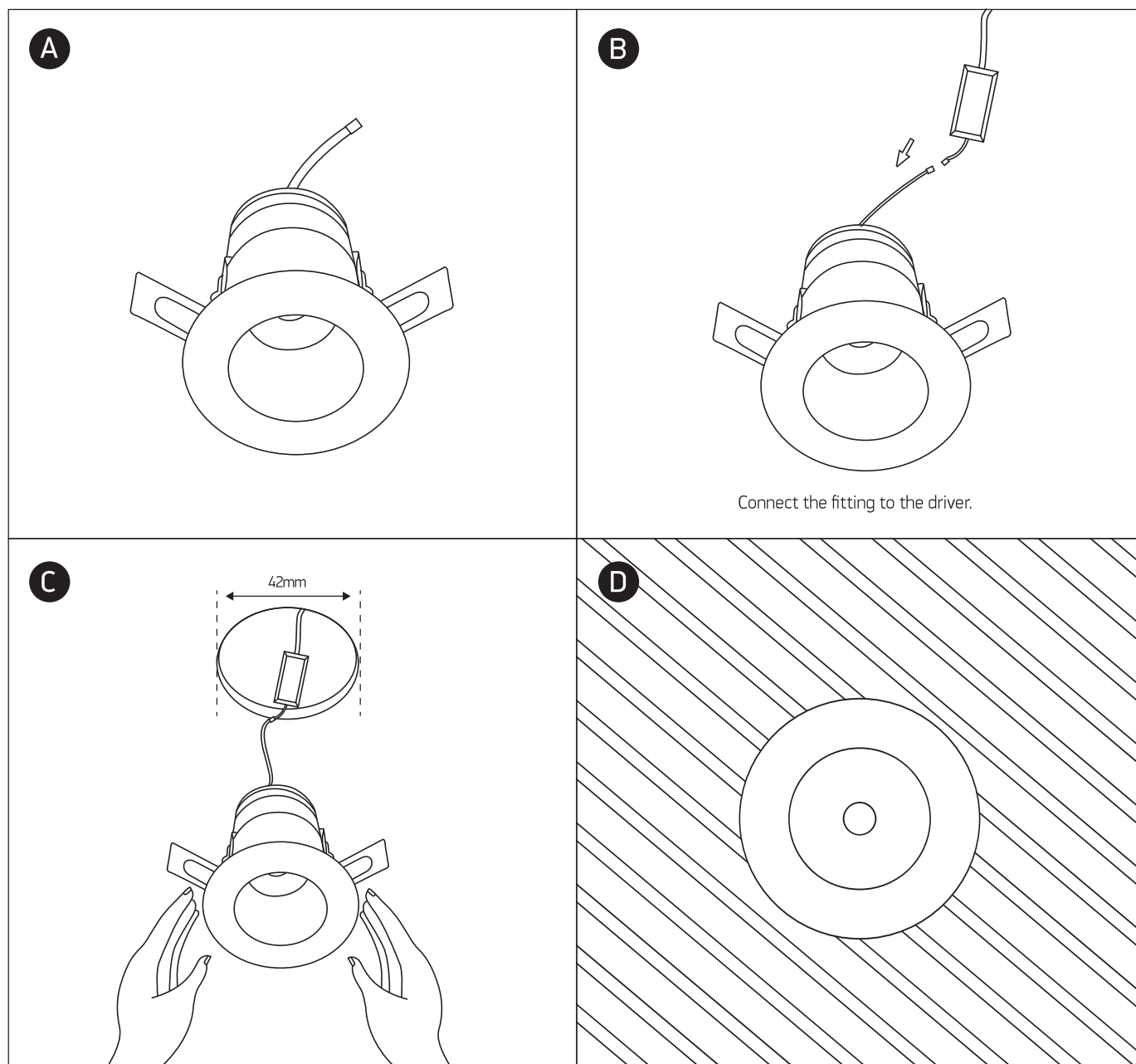
**one**  
LIGHT

### Warnings:

1. Make sure that the product is installed properly before connecting to electricity.
2. Do not cover the fitting.
3. Maintenance and installation should only be carried out by a professional electrician.