

# INSTALLATION MANUAL

## 10106DH

**ecolight**



90  
CRI



350mA | COB LED | 6W | IP20 | Die cast

Requires 350mA driver.  
Complete with honeycomb.



70mm



40mm



60mm



**one**  
LIGHT

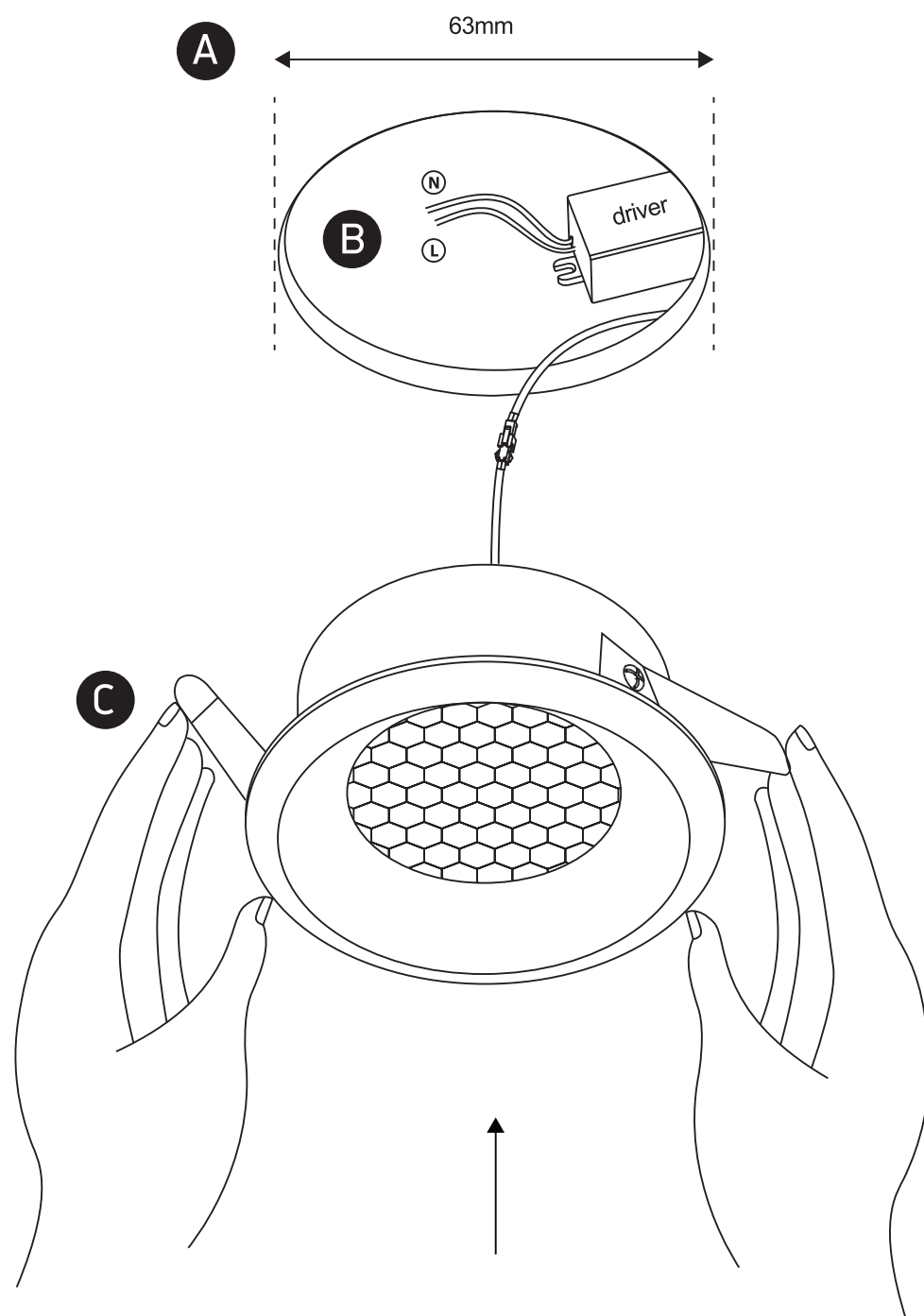

### Warnings:

1. Make sure that the product is installed properly before connecting to electricity.
2. Do not cover the fitting.
3. Maintenance and installation should only be carried out by a professional electrician.