

PRODUCT DATASHEET

DL COMFORT DN 205 20 W 3CCT IP54 WT

DOWNLIGHT COMFORT | Downlights with adjustable white light colors



AREAS OF APPLICATION

- Direct replacement for luminaires with compact fluorescent lamps
- General illumination
- Bathrooms, kitchens and sheltered outdoor areas
- Offices
- Corridors
- Foyers
- Shops
- Stairways

PRODUCT BENEFITS

- Three light color in one luminaire: Warm White, Cool White, Daylight White
- Simple installation thanks to integrated driver
- Easy installation with fast connection
- 5 years guarantee

PRODUCT FEATURES

- Three light colors selectable via slide switch
- Type of protection: IP54
- Connector box with push wire terminal for tool-free connection
- Through wiring possible



TECHNICAL DATA

Electrical data

Nominal wattage	20.00 W
Operating mode	Integrated LED driver
Nominal voltage	100...277 V
Power factor λ	>0.90
Mains frequency	50/60 Hz
Max. no. of lum. on circuit break. B16 A	13
Max. no. of lum. on circuit break. C10 A	10
Max. no. of lum. on circuit break. C16 A	17
Inrush current	50.0 A
Total harmonic distortion	< 20 %
Inrush current time T_{h50}	100 μ s

Photometrical data

Color temperature	3000...5700 K ¹⁾
Luminous flux	1720...1930 lm ²⁾
Luminous efficacy	90 lm/W ³⁾
Standard deviation of color matching	<5 sdc _m
Light color (designation)	Warm White/Cool White/Cool Daylight
Color rendering index Ra	>80

¹⁾ Color temperature switchable: 3000 K, 4000 K, 5700 K

²⁾ Luminous flux dependent on selected color temperature: 1720 lm@3000 K/1930 lm@4000 K/1810 lm@5700 K

³⁾ Value at 5700 K, different for other color temperatures

Light technical data

Beam angle	60 °
UGR lateral	<22
UGR longitudinal	<22

Dimensions & weight

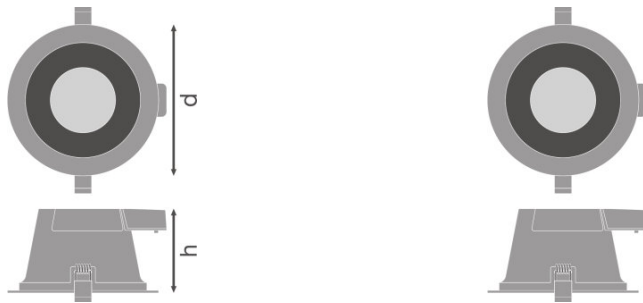

Diameter	228.0 mm
Height	98.0 mm
Product weight	550.00 g
Mounting diameter	205.0 mm

Colors & materials

Body material	Aluminum
Product color	White
Housing color	White
Cover material	Polymethylmethacrylate (PMMA)

Temperatures & operating conditions

Ambient temperature range	-20...+45 °C
----------------------------------	--------------

Lifespan

Number of switching cycles	50000
Lifespan L70/B50 at 25 °C	50000 h
Lifespan L80/B10 at 25 °C	43000 h
Lifespan L90/B10 at 25 °C	30000 h

Additional product data

Mounting type	Recessed
Mounting location	Ceiling

Capabilities

Dimmable	No
Type of connection	Screwless terminal, 2-Pole
LED module replaceable	Not replaceable

Certificates & standards

Protection class IK (shock resistance)	IK03
Glow Wire Test according to IEC 60695-2-12	650 °C
Photobio. safety group acc. to EN62471	RG0
Protection class	I
Type of protection	IP54/IP20
Standards	CE/CB/ENEC/TÜV SÜD/RoHS

LOGISTICAL DATA

Product code	Packaging unit (Pieces/Unit)	Dimensions (length x width x height)	Gross weight	Volume
4058075104105	Folding carton box 1	250 mm x 250 mm x 140 mm	667.00 g	8.75 dm ³
4058075104112	Shipping carton box 8	520 mm x 520 mm x 300 mm	7350.00 g	81.12 dm ³

The mentioned product code describes the smallest quantity unit which can be ordered. One shipping unit can contain one or more single products. When placing an order, for the quantity please enter single or multiples of a shipping unit.

ADDITIONAL CATALOG INFORMATION

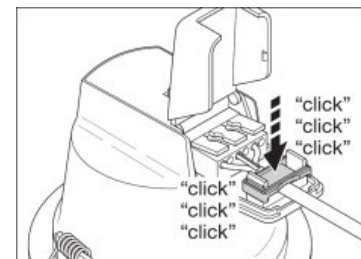
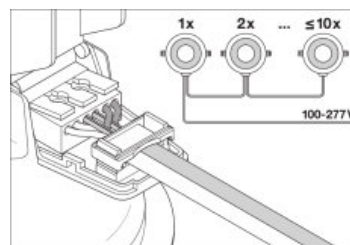
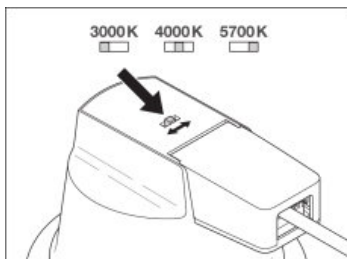

REFERENCES / LINKS

For Guarantee see

▶ www.ledvance.com/guarantee

DISCLAIMER

Subject to change without notice. Errors and omission excepted. Always make sure to use the most recent release.